

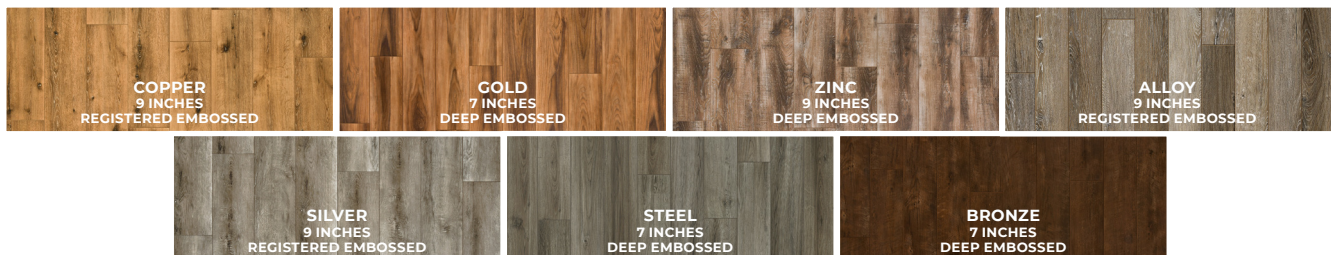

ELEMENTS SPC

Inspired by the elements of the earth, this collection pairs the strength of stone with the aesthetic of wood. Constructed with an ultra-durable, water-resistant SPC (Stone Polymer Composite) core with an attached EVA foam underlayment, precisely micro-beveled edges, and available in seven and nine inch widths, every color in this collection is a smart and stylish choice. From the warm, rich tones of Copper and Gold, to the cool, modern looks of Alloy and Steel - and everything in between - any option in the Elements collection will become the key element of your interior space.

WIDTH	7 inches, 9 inches (see below)	SURFACE TEXTURE	Varies (see below)
THICKNESS	6.5 mm	FINISH	UV Coating and Tempering
LENGTH	5 feet	WEIGHT PER BOX	7 inches : 50 lbs 9 inches : 48 lbs
WEAR LAYER	0.5 mm (20 mil)	COVERAGE PER BOX	7 inches : 24.14 sq ft 9 inches : 22.88 sq ft
CONSTRUCTION	SPC Vinyl with EVA Underlayment	EDGE DETAIL	Painted Micro-Bevel



INSTALLATION

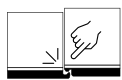

EASY CLICK

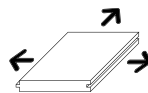

FLOATING

MOULDINGS AVAILABLE



TREAD



NOSING



REDUCER



QUARTER
ROUND

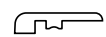

END CAP



T-MOULDING



RESILIENT

Versatile. Sensible. Effortless.

The Resilient line of Garrison floors represents a wide range of easy-to-install, high quality vinyl and laminate options. Get the look and feel of real hardwood flooring with the proven durability of Garrison water-resistant technology.



SCAN WITH
PHONE CAMERA FOR
IMAGES AND MORE
INFORMATION

www.garrisoncollection.com

(800) 300-5158 | info@garrisoncollection.com

Sample Variation Disclaimer: Due to the natural variations in color, grain, and texture inherent in the hardwood products used to design this flooring, flooring will vary from plank to plank and may vary slightly from these samples. Please expect variation in all flooring. Samples that have been exposed to sunlight or naturally aged may differ slightly from the product received. Garrison accepts no liability for claims due to variations in color, grain, and/or character between these samples and your installed floor. INSTALLATION IS ACCEPTANCE.

Product Disclaimer: All measurements are nominal. Wear layer refers to top layer thickness prior to treatment. Embossing may marginally affect wear layer thickness. All boxes include starter boards.

Order Disclaimer: We recommend buying all flooring at the same time for your project. When ordering, always factor in at least one full box for any/all unforeseen damage that may occur during the life of your floor. Please consider and allow for a waste factor of 3-5% on normal layouts and 5-10% on detailed layouts such as 45-degree angles, patterns, border work, etc. Please also include end joint stagger and note that minor imperfections are to be cut off prior to installation.

Installation Disclaimer: This flooring must be installed in accordance to our installation instructions, included in all cartons of our flooring. Proper subfloor testing must be performed and Garrison Vinyl Moisture Barrier and 3M Seam Tape (or equivalent products) must be used at installation. More detailed installation instructions can be found on our website at garrisoncollection.com. Improper installation will void your warranty.

Warranty Disclaimer: This flooring comes fully finished from the factory and requires no immediate surface treatment following installation. Improper installation or the use of improper products and/or cleaning methods will void your warranty. Please refer to full Care & Maintenance Guide available for this flooring at garrisoncollection.com.