



GARRISON

SAN MARINO OAK

## AQUA BLUE WPC

Finally, a flooring solution that is easy to install, simple to maintain, extremely durable, and looks incredible. This WPC collection features stunning colors and grain patterns that will appeal to the most discerning of critics. All Garrison WPC flooring is constructed with a uniquely composed rigid-core material that makes for a resilient, comfortable, and incredibly durable flooring option. With a thick 8mm construction, EVA foam underlayment, six foot lengths, precisely micro-beveled edges, and an embossed surface texture, all flooring in our Aquablue collection looks and feels amazing.

<b>WIDTH</b>	7 inches	<b>SURFACE TEXTURE</b>	Deep Embossed
<b>THICKNESS</b>	8 mm	<b>FINISH</b>	UV Coating and Tempering
<b>LENGTH</b>	6 feet	<b>WEIGHT PER BOX</b>	46 lbs
<b>WEAR LAYER</b>	0.5 mm (20 mil)	<b>COVERAGE PER BOX</b>	28.05 sqft
<b>CONSTRUCTION</b>	WPC Vinyl with EVA Underlayment	<b>EDGE DETAIL</b>	Painted Micro-Bevel

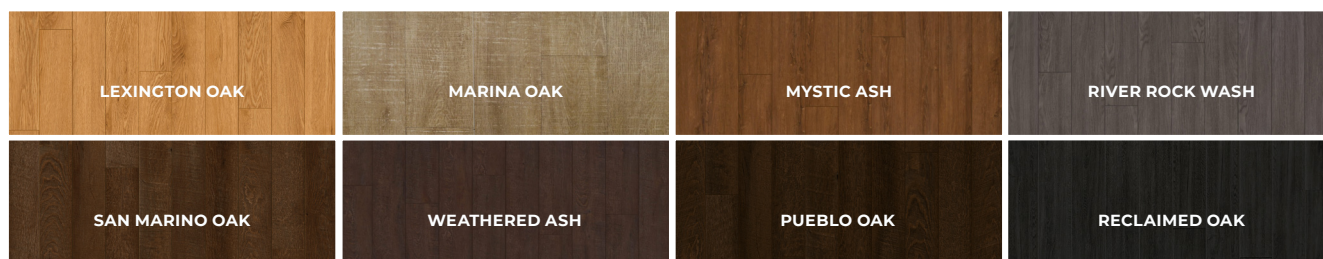

### INSTALLATION

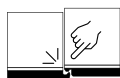

EASY CLICK

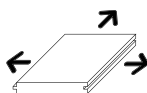

FLOATING

### MOULDINGS AVAILABLE



TREAD



NOSING



T-MOULDING



REDUCER



QUARTER  
ROUND



END  
CAP



PHTHALATE  
FREE



WATER-RESISTANT  
FLOORING



## RESILIENT

Versatile. Sensible. Effortless.

The Resilient line of Garrison floors represents a wide range of easy-to-install, high quality vinyl and laminate options. Get the look and feel of real hardwood flooring with the proven durability of Garrison water-resistant technology.



SCAN WITH  
PHONE CAMERA FOR  
IMAGES AND MORE  
INFORMATION

[www.garrisoncollection.com](http://www.garrisoncollection.com)

(800) 300-5158 | [info@garrisoncollection.com](mailto:info@garrisoncollection.com)

**Sample Variation Disclaimer:** Due to the natural variations in color, grain, and texture inherent in the hardwood products used to design this flooring, flooring will vary from plank to plank and may vary slightly from these samples. Please expect variation in all flooring. Samples that have been exposed to sunlight or naturally aged may differ slightly from the product received. Garrison accepts no liability for claims due to variations in color, grain, and/or character between these samples and your installed floor. INSTALLATION IS ACCEPTANCE.

**Product Disclaimer:** All measurements are nominal. Wear layer refers to top layer thickness prior to treatment. Embossing may marginally affect wear layer thickness. All boxes include starter boards.

**Order Disclaimer:** We recommend buying all flooring at the same time for your project. When ordering, always factor in at least one full box for any/all unforeseen damage that may occur during the life of your floor. Please consider and allow for a waste factor of 3-5% on normal layouts and 5-10% on detailed layouts such as 45-degree angles, patterns, border work, etc. Please also include end joint stagger and note that minor imperfections are to be cut off prior to installation.

**Installation Disclaimer:** This flooring must be installed in accordance to our installation instructions, included in all cartons of our flooring. Proper subfloor testing must be performed and Garrison Vinyl Moisture Barrier and 3M Seam Tape (or equivalent products) must be used at installation. More detailed installation instructions can be found on our website at [garrisoncollection.com](http://garrisoncollection.com). Improper installation will void your warranty.

**Warranty Disclaimer:** This flooring comes fully finished from the factory and requires no immediate surface treatment following installation. Improper installation or the use of improper products and/or cleaning methods will void your warranty. Please refer to full Care & Maintenance Guide available for this flooring at [garrisoncollection.com](http://garrisoncollection.com).